

NOTES:

- 1) All landscape construction and plant material to conform to B.C.L.N.A. current edition.
- 2) Required area of growing medium is 10 square metres for each tree.
- 3) Final tree locations may be varied if certified by a Landscape Architect and approved by the District.
- 4) If poor drainage conditions exist, provide positive sub-surface drainage away from planting excavation.
- 5) All trees will have a 1.82m diameter emitter loop per tree.
- 6) 12.5mm plastic emitter line to be installed 50mm below surface of growing medium. 12.5mm plastic emitter line to be pegged a minimum of every 1.5m using 200mm wire stakes or equivalent.

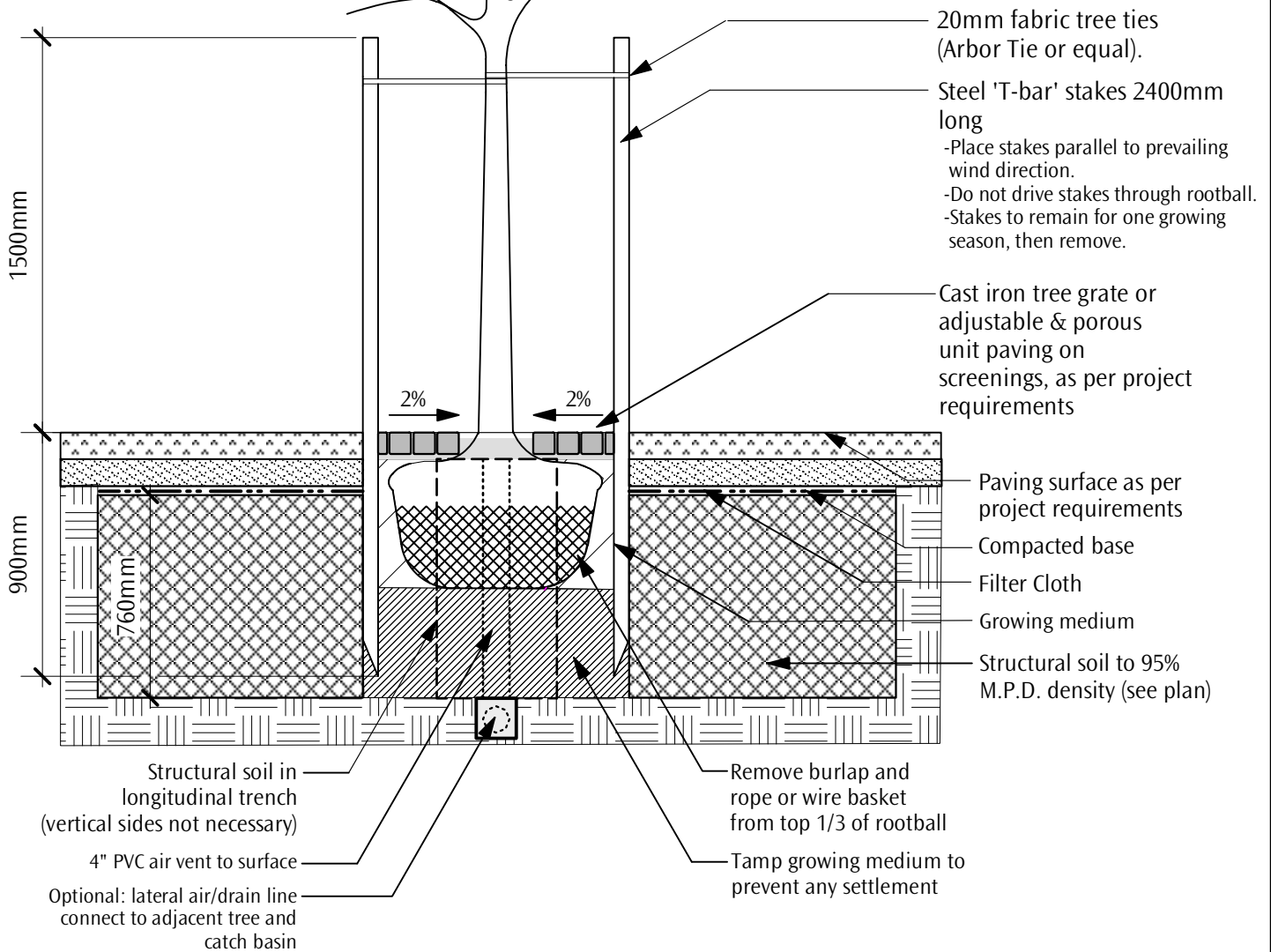

TREE PLANTING DETAIL

Structural Growing Medium Pit



CITY OF LANGFORD
ENGINEERING DEPARTMENT

DATE: 02/10/31	DRAWN: JDW	DWG No. L3(a)
SCALE: N.T.S.	APPROVED:	

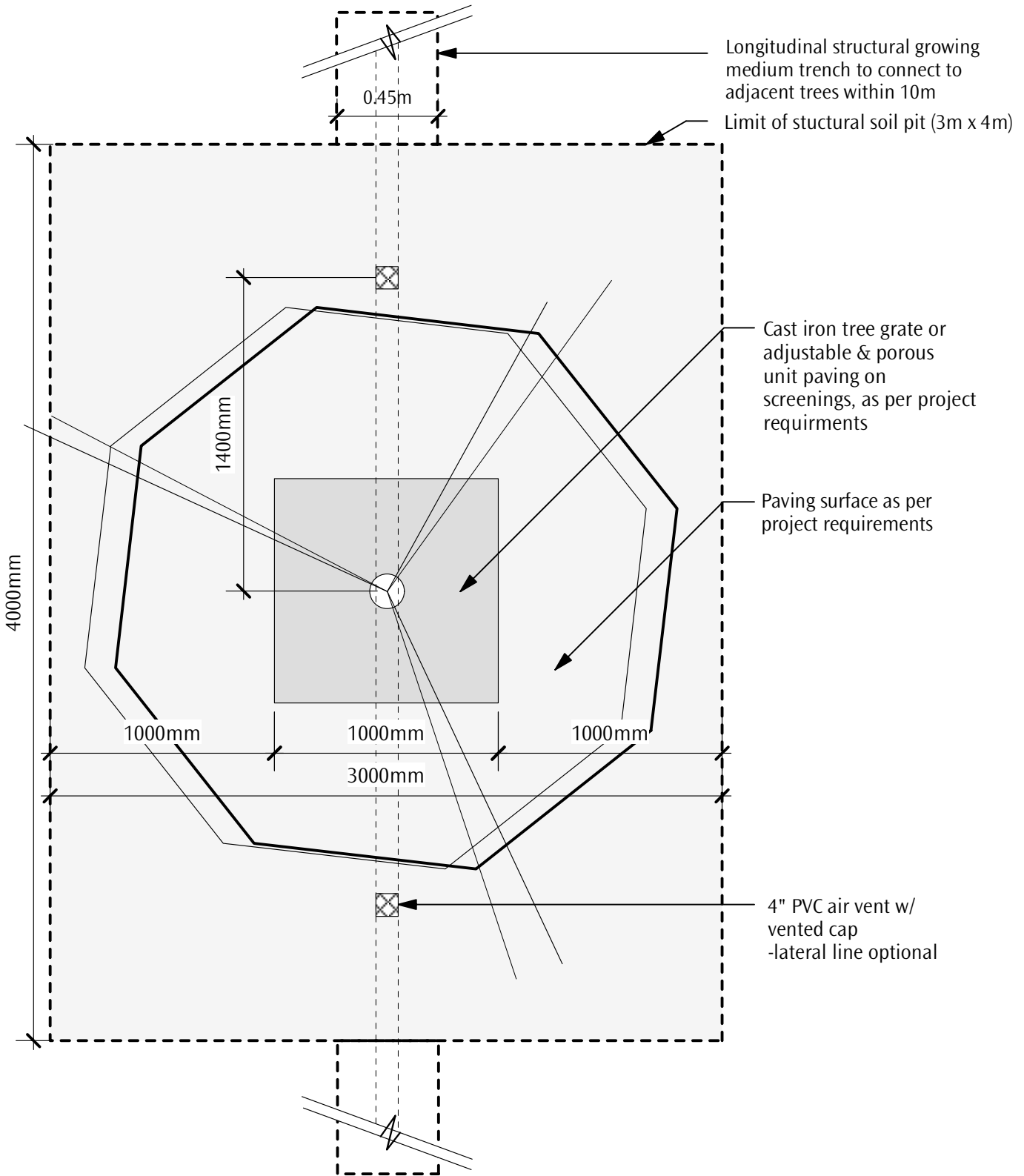

TREE PLANTING DETAIL

Structural Growing Medium Pit



CITY OF LANGFORD
ENGINEERING DEPARTMENT

DATE: 02/10/31

DRAWN: JDW

DWG No.

SCALE: N.T.S.

APPROVED:

L3(b)